

Cor-70 Hidden Sash System with thermal break

A new Euro-Groove concealed sash window design with slim profiles that are characterized by a seen surface of only 66 mm from the exterior that maximises the glazing surface and is able to reach 85% of the total window glazing. This characteristic provides an extraordinary increase in luminosity in the inside of the dwelling.

Its design allows for the hidden sash to be maintained from the outside in such a way that it is impossible to distinguish from the fixed zones that the opening has and therefore achieving perfect homogeneity in the façade's style.

A 35 mm thermally broken area and the insertion of polyolefin sponge in the frame and sash allows it to reach values of up to 1,0 W/m²K of transmission in the space and therefore maximising its energy efficiency. These high thermal performances are completed with an increased level of sound insulation that this system achieves thanks to the possibility of installing glazing units of up to 40 mm in thickness.

The classifications achieved in the AEV tests go to prove that the system has excellent water tightness, air permeability and wind resistance values in order to obtain increased protection against the most unfavourable weather conditions.



Cor-70 Hidden Sash System with thermal break

Transmittance

Uw from 1,0 (W/m²K)

Please consult typology, dimensions and glass

Acoustic insulation

Maximum glazing: 40 mm.

Maximum acoustic insulation **Rw=46 dBA**

Finishes

Possibility of dual colour

Colour powder coating (RAL, mottled and rough)

Wood effect powder coating

Anti-bacterial powder coating

Anodized

Categories achieved at test centre

Air permeability
(EN 12207:2000): Class 4

Water tightness
(EN 12208:2000): Class E1650

Wind resistance
(EN 12210:2000): Class C5
Reference test 1,23 x 1,48 m. 2 sashes

Possibility of incorporating hardware with concealed hinges.

Possibility of incorporating security hardware
Evo Security.



Sections

Frame 70 mm.
Sash 70 mm.

Profile thickness

Window 1,9 mm.

Polyamide strip length 35 mm.

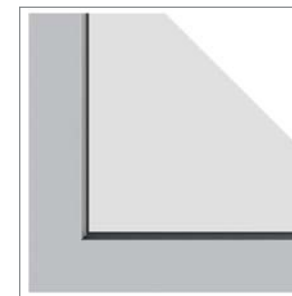
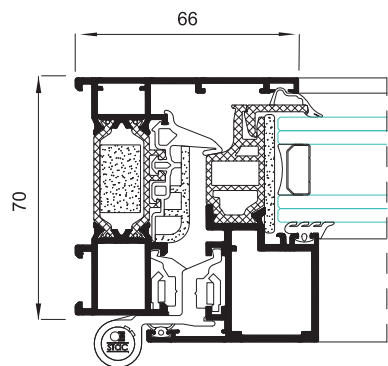

Opening possibilities



Open in:
Practicable 1 & 2 sashes,
Turn-tilt 1 & 2 sashes
Hinged

Maximum dimensions/sash

Width (L) = 1.300 mm.
Height (H) = 2.400 mm.

Please consult regarding maximum weight and dimensions according to types

Maximum weight/sash

120 Kg.